



DURAMAX[®]

EXTREME-DUTY H-SERIES CAST STAINLESS STEEL DRIVE CHAINS

10-YEAR CHAIN & SPROCKET WARRANTY
24/7/365 RELIABILITY
LOWEST LIFE-CYCLE COST

SOLUTIONS FOR TODAY, TOMORROW AND THE NEXT GENERATION.

Need an economical, cost saving solution for your Headworks, Collector and Stormwater equipment? DuraMax H78SS and H82SS Drive Chains are today's newest and best available technology.

DuraMax Drive Chains are the result of over three decades of applied field research and materials testing, and are the first CAST STAINLESS STEEL CHAINS ever manufactured for the Water and Wastewater Industry. DuraMax Chains are precision cast from aerospace-grade alloys specifically designed for extra heavy-duty, corrosive and abrasive Bar Screen, Grit Collector, and Rectangular Collector applications.

DuraMax Chains and Sprockets are designed to provide 20+ years of reliable, continuous-duty service *without repair or replacement*. Routine life-cycle maintenance costs are substantially less than any other chain and sprocket system. When evaluated over a 20-year design cycle, DuraMax Chains and Sprockets provide the greatest value and the lowest life-cycle cost compared to all other cast and fabricated metal (and many plastic) chain and sprocket systems.

DuraMax Chains also make perfect environmental and economic sense: They improve equipment effectiveness and reduce parts inventory. At the end of their service life, the high-grade stainless steel alloys will have a significant recycle value, maximizing the return on investment.



Environmental Resources, Inc.
DuraMax Chain & Equipment Products
P.O. Box 786
W278 N2968 Rocky Point Rd.
Pewaukee, WI 53072-0786

Tele: 800/691-0998
Fax: 262/691-0992

www.duramaxchain.com
www.erxinc.com

Copyright © 2008 by Environmental Resources, Inc. All rights reserved.

MAXIMUM STRENGTH. MAXIMUM CORROSION RESISTANCE. MAXIMUM ABRASION RESISTANCE.



H-SERIES DRIVE CHAIN

20-YEAR CONTINUOUS DUTY LIFE-CYCLE/10-YEAR WARRANTY:

DuraMax H78SS and H82SS Drive Chains are designed to operate for a 20-year continuous-duty service cycle on Bar Screens, Grit Collectors, and Rectangular Collectors without replacement of the chain or the sprockets, and with major reductions in maintenance and equipment downtime.

DuraMax Chains and Sprockets have a 10-Year Full Replacement Warranty when operated and maintained within chain design parameters and traditional industry standards.

On an evaluated 20-year total cost of ownership, DuraMax H82SS and H78SS Drive Chains are easier to install and substantially less expensive to operate and maintain than any other cast, fabricated steel, or 400 series stainless steel chain and sprocket system.

MAXIMUM CORROSION RESISTANCE:

DuraMax cast stainless steel alloys provide superior corrosion resistance to most major biological and chemical elements and compounds found in water and wastewater, including hydrogen sulfide, ammonia, chlorine, ferric and ferrous chlorides, alum, sodium and calcium chlorides, anoxic (septic) wastes, high temperature, high and low pH levels, and brackish waters.

CAST PRECIPITATION HARDENING STAINLESS STEEL CHAIN LINKS AND CHAIN PINS:

DuraMax Drive Chains are the strongest and most durable drive chains in their class.

DuraMax H78SS and H82SS Chain links and pins are cast from precipitation hardening aerospace-grade stainless steels, and are heat-treated and through hardened to 400 to 425 Brinell for maximum wear resistance.

DuraMax H82SS Chain (3.075" pitch) has an ultimate strength of 55,000 pounds, an ASME rated working load of 6,500 pounds, and a weight of 6.2#/foot.

DuraMax H78SS Chain (2.609" pitch) has an ultimate strength of 35,000 pounds, an ASME rated working load of 4,500 pounds, and a weight of 5.1#/foot.

MILL-TYPE SIDEBARS:

Reduces sliding wear, and provides additional load carrying capacity and longevity.

EASY-TO-INSTALL CHAIN PIN:

The "no press fit" chain pin design can be installed by hand, and without the application of mechanical force. DuraMax chain pins can also be inserted into the chain sidebars from either side of the link.

SMOOTH, NON-ABRASIVE SURFACE:

Smooth, non-porous and tight-grain investment cast surface structure designed for use on DuraMax Polymeric Sprockets.

UNIFORM DIMENSIONAL TOLERANCES:

The patented DuraMax investment casting process yields very uniform dimensional tolerances throughout each and every link cast. This eliminates the need for match-marking and shipping the chain in matched strands, and assures perfect side-to-side equipment alignment, even in very large equipment applications.

Tight tolerances between the barrel and chain pin, and between the pin boss and chain pin reduce the entry of grit, sand, and abrasives within the chain joints.

ROTATING CHAIN PIN AND PIN BOSS:

Increases bearing surface area and evenly distributes load and reduces rotating wear throughout the entire chain joint (chain pin, pin bosses and link barrel I.D.).

FULL LENGTH SIDEBAR REINFORCING RIBS:

The T-shaped sidebar provides uniform cross sectional mass across the "x" and "y" axis, resulting in exceptional chain strength and load capacity.

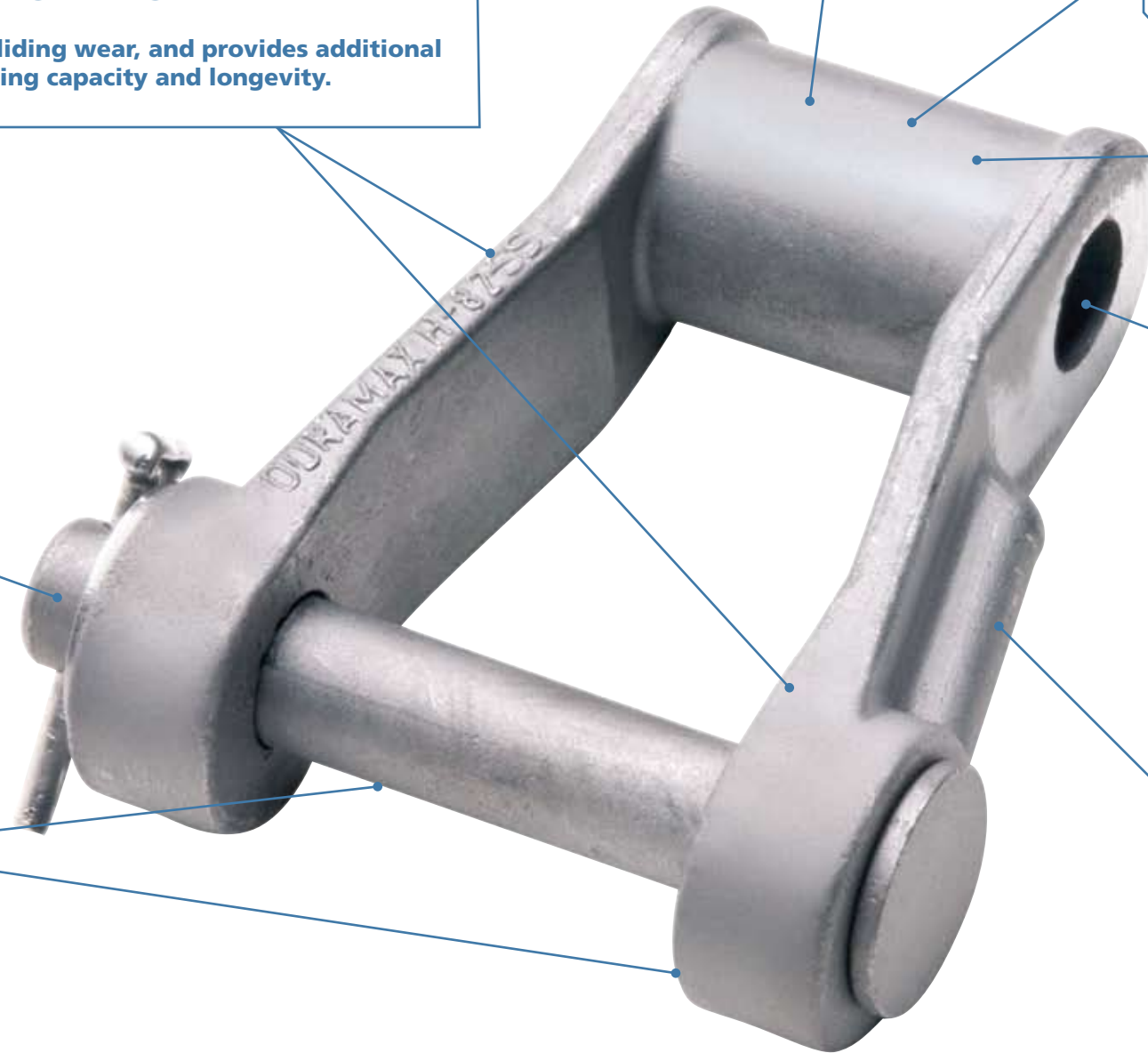

DuraMax H78SS Drive Chains are direct replacements for H78, NH78, WH78, 988, 488, 188, H77, NH77, 977, 477, H74, and H79 chains, among others. Custom attachment links are available upon request.

DuraMax H82SS Drive Chains are direct replacements for H82, NH82, WH82, C9103, C4103, 131, 102B, H87, 1030, R1033, and R1035 chains, among others. Custom attachment links are available upon request.

DURAMAX H-SERIES EXTREME-DUTY CHAIN

U.S. PATENTS 7,237,375 B2 and 7,343,730 B2 (MADE IN U.S.A.)